

RECOS[®]
PROMISE FOR EXCELLENCE



CERAMIC INDUSTRIAL BEARINGS

INDEX

Polishing Machine Bearings _____	03
- Polishing Head Bearings	
- Polishing Unit Bearings	
- Polishing Drum Bearings	
Sizing Unit Bearings _____	09
Calibration Bearings _____	12
Neno Head Bearings _____	15
Counter Pulley- Gear Bearings _____	19
All Purpose Bearings _____	22

POLISHING MACHINE BEARINGS

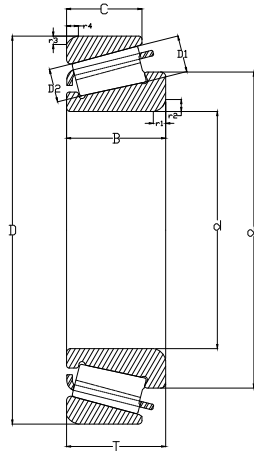

Application
Polishing Head

Bearing Type
Taper Roller Bearing

Bearing Series No.
32013

Recos Part No.
RBTR090

Technical Specification

D(OD)	d(Id)	T(Thick.)	C	B	Mass	C1	C0	LS	RS	d1	Tol.	Temp.
100.000 mm	65.000 mm	23.000 mm	17.500 mm	23.000 mm	0.64 kg	58,000 N	100,000 N	6,600 r/min	4,000 r/min	85.2 mm	PN (ISO 492:2014)	-30 to 120 degree

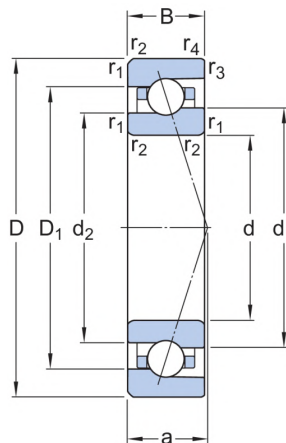

Application
Polishing Head

Bearing Type
Angular Con. Bearing

Bearing Series No.
7013 M

Recos Part No.
RBAC029

Technical Specification

D(OD)	d(Id)	T(Thick.)	C	B	Mass	C1	C0	LS	RS	d1	Tol.	Temp.
100.000 mm	65.000 mm	18.000 mm	-	-	0.43 kg	38,200 N	35,000 N	18,500 r/min	12,500 r/min	75.8 mm	PN (ISO 492:2014)	-30 to 120 degree

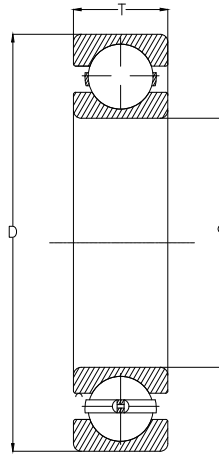

Application
Polishing Head

Bearing Type	Ball Bearing
Bearing Series No.	6305
Recos Part No.	RBB137

Technical Specification

D(OD)	d(Id)	T(Thick.)	C	B	Mass	C1	C0	Ls	Rs	d1	Tol.	Temp.
62.000 mm	25.000 mm	17.000 mm	-	-	0.23 kg	21,500 N	9,500 N	13,500 r/min	21,500 r/min	36.6 mm	PN (ISO 492:2014)	-30 to 120 degree

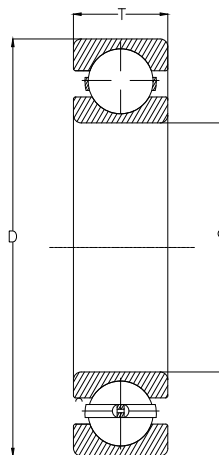

Application
Polishing Unit

Bearing Type	Ball Bearing
Bearing Series No.	6021
Recos Part No.	RBB058

Technical Specification

D(OD)	d(Id)	T(Thick.)	C	B	Mass	C1	C0	Ls	Rs	d1	Tol.	Temp.
160.000 mm	105.000 mm	26.000 mm	-	-	1.6 kg	70,500 N	63,000 N	4,800 r/min	7,600 r/min	122.5 mm	PN (ISO 492:2014)	-30 to 120 degree

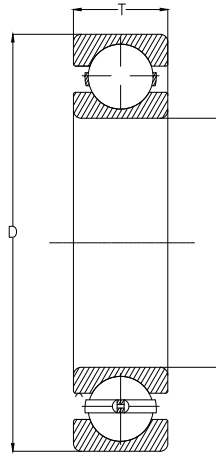

Application
Polishing Unit

Bearing Type	Ball Bearing
Bearing Series No.	6022
Recos Part No.	RBB061

Technical Specification

D(OD)	d(Id)	T(Thick.)	C	B	Mass	C1	C0	Ls	Rs	d1	Tol.	Temp.
170.000 mm	110.000 mm	28.000 mm	-	-	1.97 kg	82,200 N	72,100 N	3,200 r/min	6,400 r/min	129.05 mm	PN (ISO 492:2014)	-30 to 120 degree

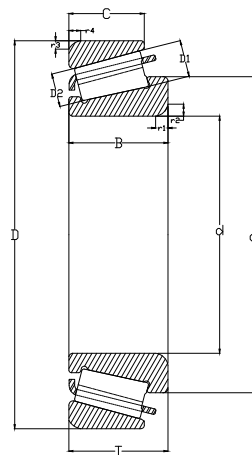

Application
Polishing Unit

Bearing Type	Taper Roller Bearing
Bearing Series No.	32011
Recos Part No.	RBTR088

Technical Specification

D(OD)	d(Id)	T(Thick.)	C	B	Mass	C1	C0	Ls	Rs	d1	Tol.	Temp.
90.000 mm	55.000 mm	23.000 mm	17.500 mm	23.000 mm	0.55 kg	60,000 N	83,000 N	7,500 r/min	4,400 r/min	75.80 mm	PN (ISO 492:2014)	-30 to 120 degree

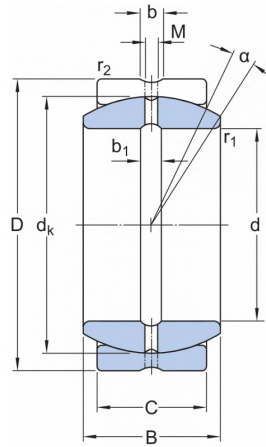

Application
Polishing Drum

Bearing Type
Spherical Bearing
Bearing Series No.
GE 40 ES
Recos Part No.
RBRS001

Technical Specification

D(OD)	d(Id)	T(Thick.)	C	B	Mass	C1	C0	Ls	Rs	d1	Tol.	Temp.
62.000 mm	40.000 mm	-	22.000 mm	28.000 mm	-	90,200 N	425,000 N	-	-	-	PN (ISO 492:2014)	-30 to 120 degree

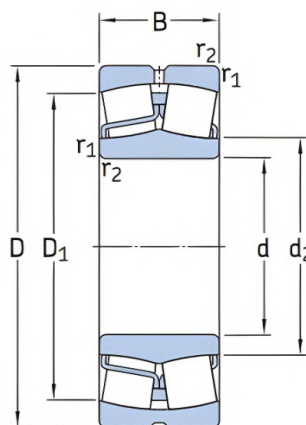

Application
Polishing Drum

Bearing Type
Spherical Bearing
Bearing Series No.
22216 CC W33
Recos Part No.
RBSH017

Technical Specification

D(OD)	d(Id)	T(Thick.)	C	B	Mass	C1	C0	Ls	Rs	d1	Tol.	Temp.
140.000 mm	80.000 mm	33.000 mm	-	-	2.05 kg	210,000 N	225,000 N	4,700 r/min	3,700 r/min	-	PN (ISO 492:2014)	-30 to 120 degree

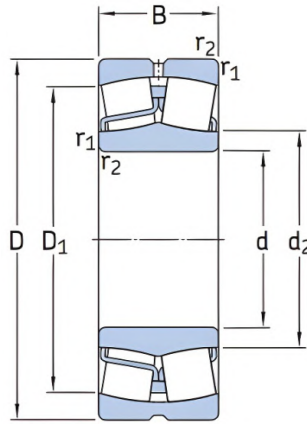
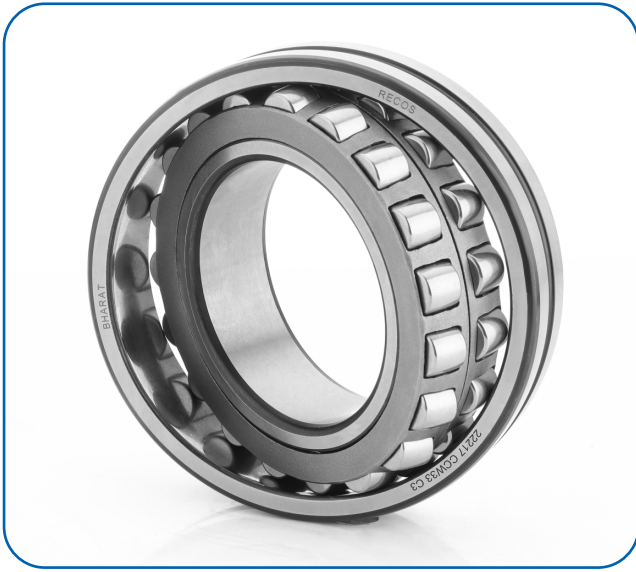

Application
Polishing Drum

Bearing Type
Spherical Bearing
Bearing Series No.
22217 CC W33
Recos Part No.
RBSH019

Technical Specification

D(OD)	d(Id)	T(Thick.)	C	B	Mass	C1	C0	Ls	Rs	d1	Tol.	Temp.
150.000 mm	85.000 mm	36.000 mm	-	-	2.65 kg	260,000 N	300,000 N	4,800 r/min	3,200 r/min	-	PN (ISO 492:2014)	-30 to 120 degree

SIZING UNIT BEARINGS

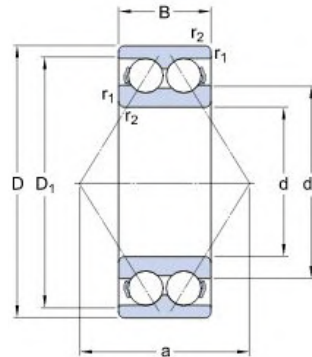

**Application
Sizing Unit**

Bearing Type
Angular Con. Bearing

Bearing Series No.
3310

Recos Part No.
RBAC020

Technical Specification

D(OD)	d(Id)	T(Thick.)	C	B	Mass	C1	C0	Ls	Rs	d1	Tol.	Temp.
110.000 mm	50.000 mm	44.000 mm	-	-	1.7 kg	89,500 N	63,500 N	5,400 r/min	5,400 r/min	-	PN (ISO 492:2014)	-30 to 120 degree

3310

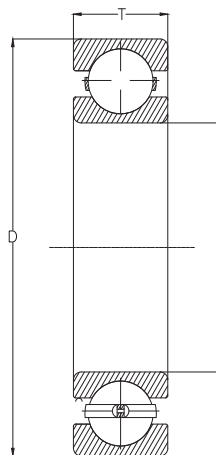

**Application
Sizing Unit**

Bearing Type
Ball Bearing

Bearing Series No.
6308

Recos Part No.
RBB146

Technical Specification

D(OD)	d(Id)	T(Thick.)	C	B	Mass	C1	C0	Ls	Rs	d1	Tol.	Temp.
90.000 mm	40.000 mm	23.000 mm	-	-	0.63 kg	39,900 N	21,200 N	8,500 r/min	15,200 r/min	56.11 mm	PN (ISO 492:2014)	-30 to 120 degree

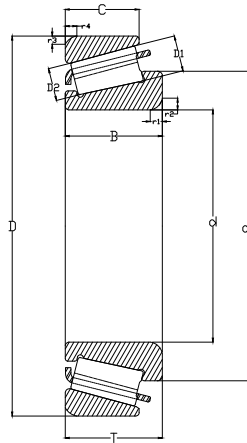

Application Sizing Unit

Bearing Type
Taper Roller Bearing

Bearing Series No.
32017

Recos Part No.
RBTR094

Technical Specification

D(OD)	d(Id)	T(Thick.)	C	B	Mass	C1	C0	Ls	Rs	d1	Tol.	Temp.
130.000 mm	85.000 mm	29.000 mm	22.000 mm	22.000 mm	1.345 kg	111,000 N	184,000 N	5,000 r/min	3,150 r/min	109,50 r/min	PN (ISO 492:2014)	-30 to 120 degree

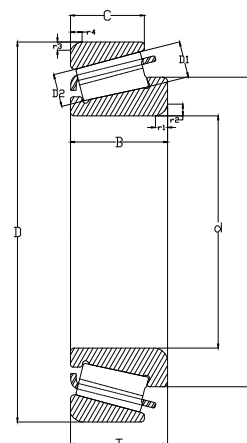

Application Sizing Unit

Bearing Type
Taper Roller Bearing

Bearing Series No.
32019

Recos Part No.
RBTR096

Technical Specification

D(OD)	d(Id)	T(Thick.)	C	B	Mass	C1	C0	Ls	Rs	d1	Tol.	Temp.
145.000 mm	90.000 mm	32.000 mm	24.000 mm	32.000 mm	1.790 kg	127,500 N	192,500 N	4,500 r/min	2,800 r/min	121 mm	PN (ISO 492:2014)	-30 to 120 degree

CALIBRATION BEARINGS

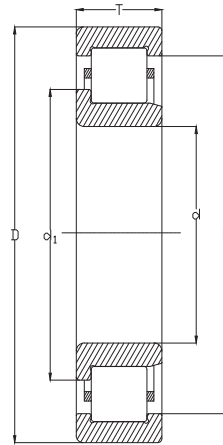
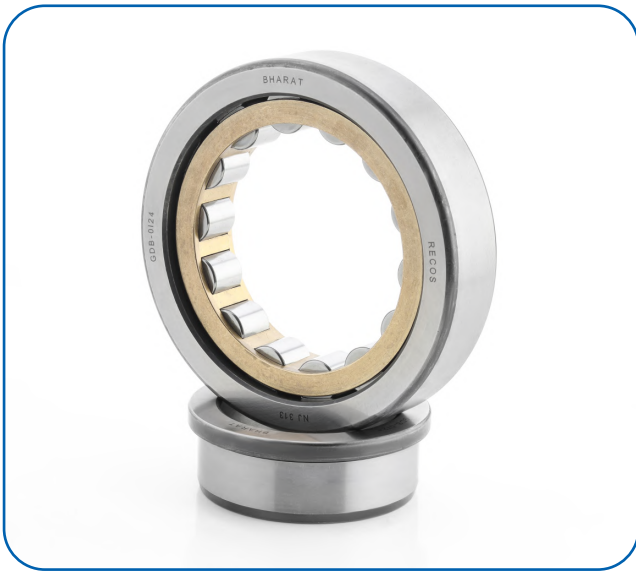

**Application
Calibration**

Bearing Type
Cylindrical Bearing
Bearing Series No.
NJ 313 M
Recos Part No.
RBCR107

Technical Specification

D(OD)	d(ld)	T(Thick.)	Mass	C1	C0	Ls	Rs	d1	F	Tol.	Temp.
140.000 mm	65.000 mm	33.000 mm	2.3 kg	1,90,000 N	2,02,000 N	5,500 r/min	4,850 r/min	117,500 r/min	24,500 N	PN (ISO 492:2014)	-30 to 120 degree

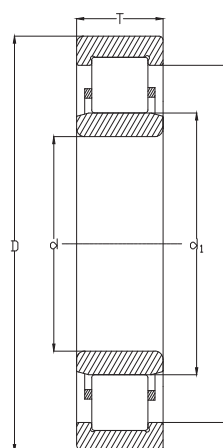

**Application
Calibration**

Bearing Type
Cylindrical Bearing
Bearing Series No.
NU 313 M
Recos Part No.
RBCR106

Technical Specification

D(OD)	d(ld)	T(Thick.)	Mass	C1	C0	Ls	Rs	d1	F	Tol.	Temp.
140.000 mm	65.000 mm	33.000 mm	2.2 kg	1,90,000 N	2,02,000 N	5,500 r/min	4,800 r/min	117,500 r/min	24,500 N	PN (ISO 492:2014)	-30 to 120 degree

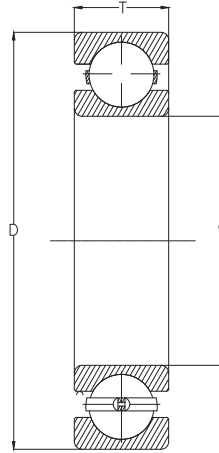
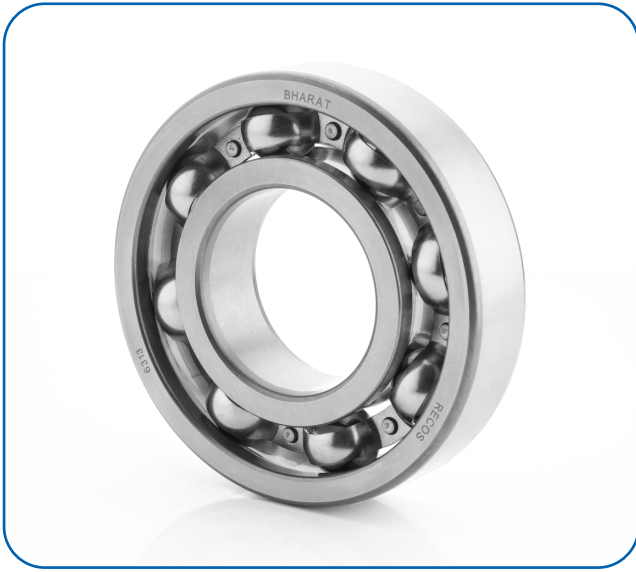

**Application
Calibration**

Bearing Type
Ball Bearing

Bearing Series No.
6313

Recos Part No.
RBB161

Technical Specification

D(OD)	d(Id)	T(Thick.)	C	B	Mass	C1	C0	Ls	Rs	d1	Tol.	Temp.
140.000 mm	65.000 mm	33.000 mm	-	-	2.11 kg	92,200 N	55,500 N	5,300 r/min	7,300 r/min	88,35 r/min	PN (ISO 492:2014)	-30 to 120 degree

NENO HEAD BEARINGS

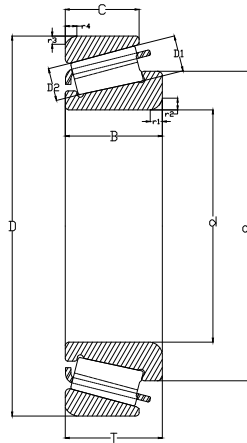

Application
Neno Head

Bearing Type
Taper Roller Bearing

Bearing Series No.
30206

Recos Part No.
RBTR004

Technical Specification

D(OD)	d(Id)	T(Thick.)	C	B	Mass	C1	C0	Ls	Rs	d1	Tol.	Temp.
62.000 mm	30.000 mm	17.250 mm	14.000 mm	16.000 mm	0.230 kg	42,500 N	47,500 N	12,000 r/min	7,000 r/min	46,200 r/min	PN (ISO 492:2014)	-30 to 120 degree

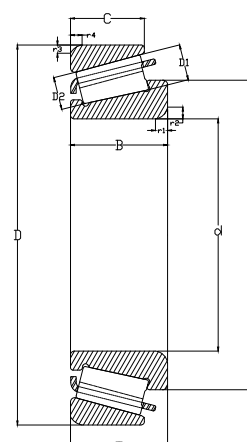

Application
Neno Head

Bearing Type
Taper Roller Bearing

Bearing Series No.
30207

Recos Part No.
RBTR005

Technical Specification

D(OD)	d(Id)	T(Thick.)	C	B	Mass	C1	C0	Ls	Rs	d1	Tol.	Temp.
72.000 mm	35.000 mm	18.250 mm	15.000 mm	17.000 mm	0.320 kg	43,000 N	46,000 N	10,300 r/min	6,200 r/min	52,650 mm	PN (ISO 492:2014)	-30 to 120 degree

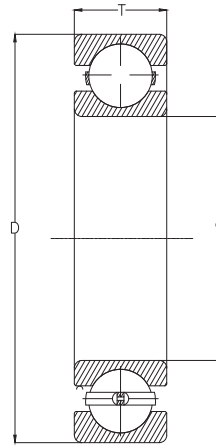

Application
Neno Head

Bearing Type	Ball Bearing
Bearing Series No.	6212
Recos Part No.	RBB102

Technical Specification

D(OD)	d(Id)	T(Thick.)	C	B	Mass	C1	C0	Ls	Rs	d1	Tol.	Temp.
110.000 mm	60.000 mm	22.000 mm	-	-	0.78 kg	52,500 N	33,100 N	6,800 r/min	11,200 r/min	75,50 r/min	PN (ISO 492:2014)	-30 to 120 degree

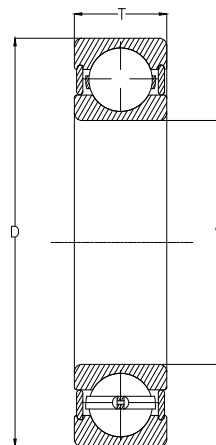

Application
Neno Head

Bearing Type	Ball Bearing
Bearing Series No.	6206 2RS
Recos Part No.	RBCR086

Technical Specification

D(OD)	d(Id)	T(Thick.)	C	B	Mass	C1	C0	Ls	Rs	d1	Tol.	Temp.
62.000 mm	30.000 mm	16.000 mm	-	-	0.2 kg	16,600 N	9,000 N	-	6,200 r/min	40.36 mm	PN (ISO 492:2014)	-30 to 120 degree

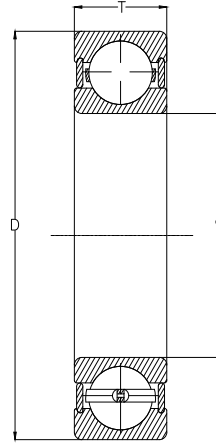
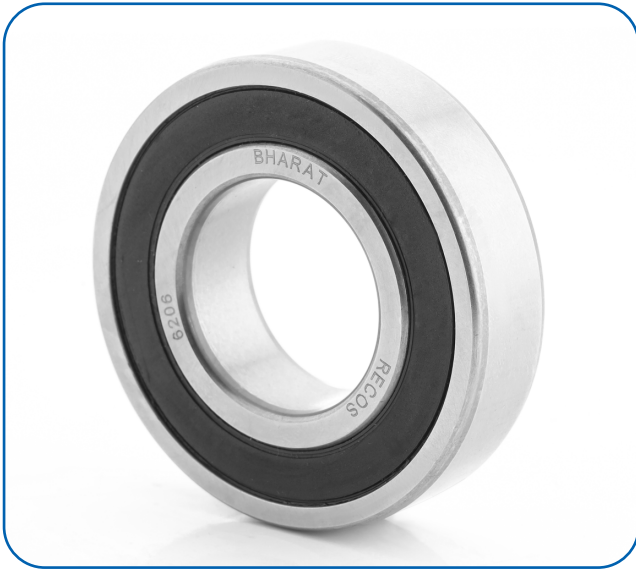

Application
Neno Head

Bearing Type	Ball Bearing
Bearing Series No.	6207 2RS
Recos Part No.	RBB089

Technical Specification

D(OD)	d(Id)	T(Thick.)	C	B	Mass	C1	C0	Ls	Rs	d1	Tol.	Temp.
72.000 mm	35.000 mm	17.000 mm	-	-	0.3 kg	24,000 N	14,100 N	-	5,000 r/min	46,94 r/min	PN (ISO 492:2014)	-30 to 120 degree

COUNTER PULLEY - GEAR BEARINGS

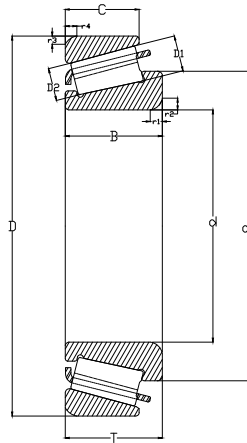

Application
Counter Pulley - Gear

Bearing Type
Taper Roller Bearing
Bearing Series No.
32224
Recos Part No.
RBTR139

Technical Specification

D(OD)	d(Id)	T(Thick.)	C	B	Mass	C1	C0	Ls	Rs	d1	Tol.	Temp.
215.000 mm	120.000 mm	61.500 mm	50.000 mm	58.000 mm	9.30 kg	425,000 N	670,000 N	3,000 r/min	2,050 r/min	165,20 r/min	PN (ISO 492:2014)	-30 to 120 degree

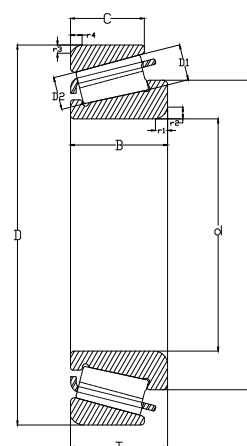

Application
Counter Pulley - Gear

Bearing Type
Taper Roller Bearing
Bearing Series No.
32315
Recos Part No.
RBTR419

Technical Specification

D(OD)	d(Id)	T(Thick.)	C	B	Mass	C1	C0	Ls	Rs	d1	Tol.	Temp.
160.000 mm	75.000 mm	58.000 mm	45.000 mm	58.000 mm	5.2 kg	375,000 N	450,000 N	2,700 r/min	2,900 r/min	113,20 mm	PN (ISO 492:2014)	-30 to 120 degree

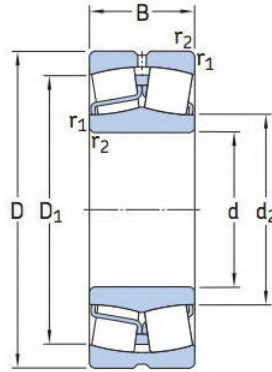

Application
Counter Pulley - Gear

Bearing Type
Spherical Bearing
Bearing Series No.
22236 CC W33 C3
Recos Part No.
RBS065

Technical Specification

D(OD)	d(Id)	T(Thick.)	C	B	Mass	C1	C0	Ls	Rs	d1	Tol.	Temp.
320.000 mm	180.000 mm	86.000 mm	-	-	29.2 kg	1110,000 N	1260,000 N	2,000 r/min	1,700 r/min	-	PN (ISO 492:2014)	-30 to 120 degree

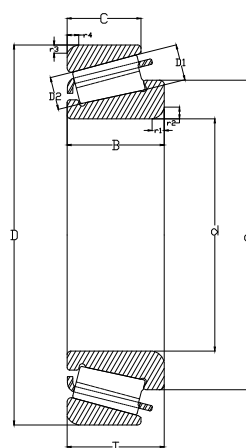

Application
Counter Pulley - Gear

Bearing Type
Taper Roller Bearing
Bearing Series No.
32236
Recos Part No.
RBTR420

Technical Specification

D(OD)	d(Id)	T(Thick.)	C	B	Mass	C1	C0	Ls	Rs	d1	Tol.	Temp.
320.000 mm	180.000 mm	91.000 mm	71.000 mm	86.000 mm	29.50 kg	980,000 N	1320,000 N	1,600 r/min	1,200 r/min	247.20 mm	PN (ISO 492:2014)	-30 to 120 degree



**ALL PURPOSE
BEARINGS**

Sr. No.	Series	D(OD)	d(ID)	T(Thickness)	Weight(kg)
RBB001	6000-ZZ	26	10	8	0.02
RBB002	6000-2RS	26	10	8	0.02
RBB003	6001-ZZ	28	12	8	0.02
RBB004	6001-2RS	28	12	8	0.02
RBB005	6003-27	35	17	10	0.04
RBB006	6003-2RS	35	17	10	0.04
RBB007	6004	42	20	12	0.07
RBB008	6004-ZZ	42	20	12	0.07
RBB009	6004-2RS	42	20	12	0.07
RBB010	6005	47	25	12	0.08
RBB011	6005-ZZ	47	25	12	0.08
RBB012	6005-2RS	47	25	12	0.08
RBB013	6006	55	30	13	0.12
RBB014	6006-ZZ	55	30	13	0.12
RBB015	6006-285	55	30	13	0.12
RBB016	6007	62	35	14	0.1466
RBB017	6007-ZZ	62	35	14	0.1466
RBB018	6007-2RS	62	35	14	0.1466
RBB019	6008	68	40	15	0.19
RBB020	6008-ZZ	68	40	15	0.19
RBB021	6008-2RS	68	40	15	0.19
RBB022	6009	75	45	16	0.24
RBB023	6009-ZZ	75	45	16	0.24
RBB024	6009-2RS	75	45	16	0.24
RBB025	6010	80	50	16	0.26
RBB026	6010-ZZ	80	50	16	0.26
RBB027	6010-2RS	80	50	16	0.26
RBB028	6011	90	55	18	0.39
RBB029	6011-ZZ	90	55	18	0.39
RBB030	6011-2RS	90	55	18	0.39
RBB031	6012	95	60	18	0.42
RBB032	6012-ZZ	95	60	18	0.42
RBB033	6012-2RS	95	60	18	0.42
RBB034	6013	100	65	18	0.44
RBB035	6013-ZZ	100	65	18	0.44
RBB036	6013-2RS	100	65	18	0.44
RBB037	6014	110	70	20	0.6

Sr. No.	Series	D(OD)	d(ID)	T(Thickness)	Weight(kg)
RBB038	6014-ZZ	110	70	20	0.6
RBB039	6014-2RS	110	70	20	0.6
RBB040	6015	115	75	20	0.64
RBB041	6015-ZZ	115	75	20	0.64
RBB042	6015-2RS	115	75	20	0.64
RBB043	6016	125	80	22	0.86
RBB044	6016-ZZ	125	80	22	0.86
RBB045	6016-2RS	125	80	22	0.86
RBB046	6017	130	85	22	0.9
RBB047	6017-ZZ	130	85	22	0.9
RBB048	6017-2RS	130	85	22	0.9
RBB049	6018	140	90	24	1.15
RBB050	6 018-ZZ	140	90	24	1.15
RBB051	6018-2RS	140	90	24	1.15
RBB052	6019	145	95	24	1.15
RBB053	6019-ZZ	145	95	24	1.15
RBB054	6019-2RS	145	95	24	1.15
RBB055	6020	150	100	24	1.26
RBB056	6020-ZZ	150	100	24	1.26
RBB057	6020-2RS	150	100	24	1.26
RBB058	6021	160	105	26	1.6
RBB059	6021-ZZ	160	105	26	1.6
RBB060	6021-2RS	160	105	26	1.6
RBB061	6022	170	110	28	1.97
RBB062	6022-ZZ	170	110	28	1.97
RBB063	6022-2RS	170	110	28	1.97
RBB064	6024	180	120	28	2.1
RBB065	6024-ZZ	180	120	28	2.1
RBB066	6024-2RS	180	120	28	2.2
RBB067	6200-ZZ	30	10	9	0.034
RBB068	6200-2RS	30	10	9	0.034
RBB069	6201	32	12	10	0.037
RBB070	6201-ZZ	32	12	10	0.037
RBB071	6201-2RS	32	12	10	0.039
RBB072	6202	35	15	11	0.045
RBB073	6202-ZZ	35	15	11	0.048
RBB074	6202-2RS	35	15	11	0.046

Sr. No.	Series	D(OD)	d(ID)	T(Thickness)	Weight(kg)
RBB075	6203	40	17	12	0.065
RBB076	6203-ZZ	40	17	12	0.067
RBB077	6203-2RS	40	17	12	0.067
RBB078	6204	47	20	14	0.11
RBB079	6204-ZZ	47	20	14	0.11
RBB080	6204-2RS	47	20	14	0.11
RBB081	6205	52	25	15	0.13
RBB082	6205-ZZ	52	25	15	0.13
RBB083	6205-2RS	52	25	15	0.13
RBB084	6206	62	30	16	0.2
RBB085	6206-ZZ	62	30	16	0.2
RBB086	6206-2RS	62	30	16	0.21
RBB087	6207	72	35	17	0.29
RBB088	6207-ZZ	72	35	17	0.29
RBB089	6207-2RS	72	35	17	0.3
RBB090	6208	80	40	18	0.37
RBB091	6208-ZZ	80	40	18	0.38
RBB092	6208-2RS	80	40	18	0.38
RBB093	6209	85	45	19	0.42
RBB094	6209-ZZ	85	45	19	0.43
RBB095	6209-2RS	85	45	19	0.43
RBB096	6210	90	50	20	0.46
RBB097	6210-ZZ	90	50	20	0.47
RBB098	6210-2RS	90	50	20	0.47
RBB099	6211	100	55	21	0.61
RBB100	6211-ZZ	100	55	21	0.64
RBB101	6211-2RS	100	55	21	0.64
RBB102	6212	110	60	22	0.78
RBB103	6212-ZZ	110	60	22	0.81
RBB104	6212-2RS	110	60	22	0.81
RBB105	6213	120	65	23	1.02
RBB106	6213-ZZ	120	65	23	1.06
RBB107	6213-2RS	120	65	23	1.06
RBB108	6214	125	70	24	1.09
RBB109	6214-ZZ	125	70	24	1.09
RBB110	6214-2RS	125	70	24	1.12
RBB111	6215	130	75	25	1.19

Sr. No.	Series	D(OD)	d(ID)	T(Thickness)	Weight(kg)
RBB112	6215-ZZ	130	75	25	1.23
RBB113	6215-2RS	130	75	25	1.23
RBB114	6216	140	80	26	1.47
RBB115	6216-ZZ	140	80	26	1.53
RBB116	6216-2RS	140	80	26	1.51
RBB117	6217	150	85	28	1.8
RBB118	6217-ZZ	150	85	28	1.88
RBB119	6217-2RS	150	85	28	1.89
RBB120	6218	160	90	30	2.22
RBB121	6218-ZZ	160	90	30	2.22
RBB122	6218-2RS	160	90	30	2.31
RBB123	6300-ZZ	35	10	11	0.053
RBB124	6300-2RS	35	10	11	0.055
RBB125	6301	37	12	12	0.06
RBB126	6301-ZZ	37	12	12	0.06
RBB127	6301-2RS	37	12	12	0.062
RBB128	6302	42	15	13	0.082
RBB129	6302-ZZ	42	15	13	0.086
RBB130	6302-2RS	42	15	13	0.085
RBB131	6303	47	17	14	0.11
RBB132	6303-ZZ	47	17	14	0.12
RBB133	6303-2RS	47	17	14	0.12
RBB134	6304	52	20	15	0.14
RBB135	6304-ZZ	52	20	15	0.15
RBB136	6304-2RS	52	20	15	0.15
RBB137	6305	62	25	17	0.23
RBB138	6305-ZZ	62	25	17	0.23
RBB139	6305-2RS	62	25	17	0.23
RBB140	6306	72	30	19	0.35
RBB141	6306-ZZ	72	30	19	0.36
RBB142	6306-2RS	72	30	19	0.35
RBB143	6307	80	35	21	0.46
RBB144	6307-ZZ	80	35	21	0.48
RBB145	6307-2RS	80	35	21	0.46
RBB146	6308	90	40	23	0.63
RBB147	6308-ZZ	90	40	23	0.65
RBB148	6308-2RS	90	40	23	0.65

Sr. No.	Series	D(OD)	d(ID)	T(Thickness)	Weight(kg)
RBB149	6309	100	45	25	0.84
RBB150	6309-ZZ	100	45	25	0.87
RBB151	6309-2RS	100	45	25	0.86
RBB152	6310	110	50	27	1.08
RBB153	6310-ZZ	110	50	27	1.12
RBB154	6310-2RS	110	50	27	1.12
RBB155	6311	120	55	29	1.37
RBB156	6311-ZZ	120	55	29	1.42
RBB157	6311-2RS	120	55	29	1.41
RBB158	6312	130	60	31	1.72
RBB159	6312-ZZ	130	60	31	1.78
RBB160	6312-2RS	130	60	31	1.77
RBB161	6313	140	65	33	2.11
RBB162	6313-ZZ	140	65	33	2.11
RBB163	6313-2RS	140	65	33	2.11
RBB164	6314	150	70	35	2.55
RBB165	6314-ZZ	150	70	35	2.65
RBB166	6314-2RS	150	70	35	2.62
RBB167	6315	160	75	37	3.06
RBB168	6315-ZZ	160	75	37	3.06
RBB169	6315-2RS	160	75	37	3.13
RBB170	6316	170	80	39	3.69
RBB171	6316-ZZ	170	80	39	3.74
RBB172	6316-2RS	170	80	39	3.74
RBB173	QJ 209	85	45	19	0.52
RBB174	QJ 309 ST	100	45	25	1.05
RBB175	QJ 309 Br	100	45	25	1.05
RBB176	AMS 9	71.44	28.58	20.64	0.42
			25		

Size	Sr. No.	Series	Sr. No.	Series	Sr. No.	Series	Sr. No.	Series
12 mm	RBPB001	UCP 201	RBPB027	UCF 201	RBPB047	UCFL 201	RBPB067	UCT 201
15mm	RBPB002	UCP 202	RBPB028	UCF 202	RBPB048	UCFL 202	RBPB068	UCT 202
17mm	RBPB003	UCP 203	RBPB029	UCF 203	RBPB049	UCFL 203	RBPB069	UCT 203
3/4" - 20mm	RBPB004	UCP 204	RBPB030	UCF 204	RBPB050	UCFL 204	RBPB070	UCT 204
1" - 25mm	RBPB005	UCP 205	RBPB031	UCF 205	RBPB051	UCFL 205	RBPB071	UCT 205
30mm	RBPB006	UCP 206	RBPB032	UCF 206	RBPB052	UCFL 206	RBPB072	UCT 206
1 1/8 - 28.5mm	RBPB007	UCP 206	RBPB033	UCF 206	RBPB053	UCFL 206	RBPB073	UCT 206
1 1/4 - 35mm	RBPB008	UCP 207	RBPB034	UCF 207	RBPB054	UCFL 207	RBPB074	UCT 207
1 1/2 - 40mm	RBPB009	UCP 208	RBPB035	UCF 208	RBPB055	UCFL 208	RBPB075	UCT 208
1 3/4 - 45mm	RBPB010	UCP 209	RBPB036	UCF 209	RBPB056	UCFL 209	RBPB076	UCT 209
2" - 50mm	RBPB011	UCP 210	RBPB037	UCF 210	RBPB057	UCFL 210	RBPB077	UCT 210
2" - 55mm	RBPB012	UCP 211	RBPB038	UCF 211	RBPB058	UCFL 211	RBPB078	UCT 211
60mm	RBPB013	UCP 212	RBPB039	UCF 212	RBPB059	UCFL 212	RBPB079	UCT 212
2 1/4 - 60mm	RBPB014	UCP 212	RBPB040	UCF 212	RBPB060	UCFL 212	RBPB080	UCT 212
2 1/2 - 65mm	RBPB015	UCP 213	RBPB041	UCF 213	RBPB061	UCFL 213	RBPB081	UCT 213
70mm	RBPB016	UCP 214	RBPB042	UCF 214	RBPB062	UCFL 214	RBPB082	UCT 214
3" - 75mm	RBPB017	UCP 215	RBPB043	UCF 215	RBPB063	UCFL 215	RBPB083	UCT 215
80mm	RBPB018	UCP 216	RBPB044	UCF 216	RBPB064	UCFL 216	RBPB084	UCT 216
85mm	RBPB019	UCP 217	RBPB045	UCF 217	RBPB065	UCFL 217	RBPB085	UCT 217
90mm	RBPB020	UCP 218	RBPB046	UCF 218	RBPB066	UCFL 218		
1 1/2 EXTRA LONG	RBPB021	UCP 208						
2" EXTRA LONG	RBPB022	UCP 211						
-	RBPB023	CSB206						
-	RBPB024	CSB207						
40mm	RBPB025	CSB208						
1 1/2	RBPB026	CSB208						

Size	Sr. No.	Series	Sr. No.	Series	Sr. No.	Series	Sr. No.	Series
12 mm	RBPB086	UCHB 201	RBPB101	UCFC 201	RBPB121	UCAP 201	RBPB132	UC 201
15mm	RBPB087	UCHB 202	RBPB102	UCFC 202	RBPB122	UCAP 202	RBPB133	UC 202
17mm	RBPB088	UCHB 203	RBPB103	UCFC 203	RBPB123	UCAP 203	RBPB134	UC 203
3/4" - 20mm	RBPB089	UCHB 204	RBPB104	UCFC 204	RBPB124	UCAP 204	RBPB135	UC 204
1" - 25mm	RBPB090	UCHB 205	RBPB105	UCFC 205	RBPB125	UCAP 205	RBPB136	UC 205
30mm	RBPB091	UCHB 206	RBPB106	UCFC 206	RBPB126	UCAP 206	RBPB137	UC 206
1 1/8 - 28.5mm	RBPB092	UCHB 206	RBPB107	UCFC 206	RBPB127	UCAP 206	RBPB138	UC 206
1 1/4 - 35mm	RBPB093	UCHB 207	RBPB108	UCFC 207	RBPB128	UCAP 207	RBPB139	UC 207
1 1/2 - 40mm	RBPB094	UCHB 208	RBPB109	UCFC 208	RBPB129	UCAP 208	RBPB140	UC 208
1 3/4 - 45mm	RBPB095	UCHB 209	RBPB110	UCFC 209	RBPB130	UCAP 209	RBPB141	UC 209
2" - 50mm	RBPB096	UCHB 210	RBPB111	UCFC 210	RBPB131	UCAP 210	RBPB142	UC 210
2" - 55mm	RBPB097	UCHB 211	RBPB112	UCFC 211			RBPB143	UC 211
60mm	RBPB098	UCHB 212	RBPB113	UCFC 212			RBPB144	UC 212
2 1/4 - 60mm	RBPB099	UCHB 212	RBPB114	UCFC 212			RBPB145	UC 212
2 1/2 - 65mm	RBPB100	UCHB 213	RBPB115	UCFC 213			RBPB146	UC 213
70mm			RBPB116	UCFC 214			RBPB147	UC 214
3" - 75mm			RBPB117	UCFC 215			RBPB148	UC 215
80mm			RBPB118	UCFC 216			RBPB149	UC 216
85mm			RBPB119	UCFC 217			RBPB150	UC 217
90mm			RBPB120	UCFC 218			RBPB151	UC 218
1 1/2 EXTRA LONG							RBPB152	UC 211
2" EXTRA LONG							RBPB153	UCF 211
-							RBPB154	UC 211 2RS
-								
40mm								
1 1/2								

